

2397 Touchless Door Release



ACX 2397 Touchless Door Release is a technologically advanced sensing apparatus designed to serve as a general exit release. Unlike traditional door release buttons, this infrared-based solution eliminates the need for physical pressure to operate, offering a contactless user experience. Its compact form factor enables space-efficient installation, resulting in material cost savings for the end user.

The encrypted infrared technology mitigates interference from other infrared remote control devices. By simply waving a hand in front of the sensor, the internal relay state is changed to unlock the associated electronic lock.

The ACX 2397 Touchless Door Release is engineered to seamlessly integrate with a wide range of Access Control System deployments.

FEATURES

- Small in size, it can be conveniently installed on Asia & US electric gang boxes.
- Contactless and auto-sensing technologies, distinguishing itself from traditional door release buttons for normal operation.
- Circle Ring LED

SPECIFICATIONS

2397 Touchless Door Release	
Dimensions	86 Type - cover: 86mm(L) x 86mm(W) x 4mm(H), body: 56mm(L) x 50mm(W) x 32mm(H) 120 Type - cover: 118mm(L) x 72mm(W) x 4mm(H), body: 56mm(L) x 50mm(W) 32mm(H)
Power Input	DC12V, 5A
Output	Relay output, 5ADC 12VDC (For Electric Lock) Dry contact output for Alarm signal output
Mechanical Life	500,000 tests
Operation Temp	-20° C~ +55° C (14-131F)
Suitable Humidity	0-80% (relative humidity)
Detection Range	2cm to 10cm
Circle Ring LED	Blue (Normal Mode) Red (Emergency Exit is enabled)
Weight	200gm

DIMENSIONS

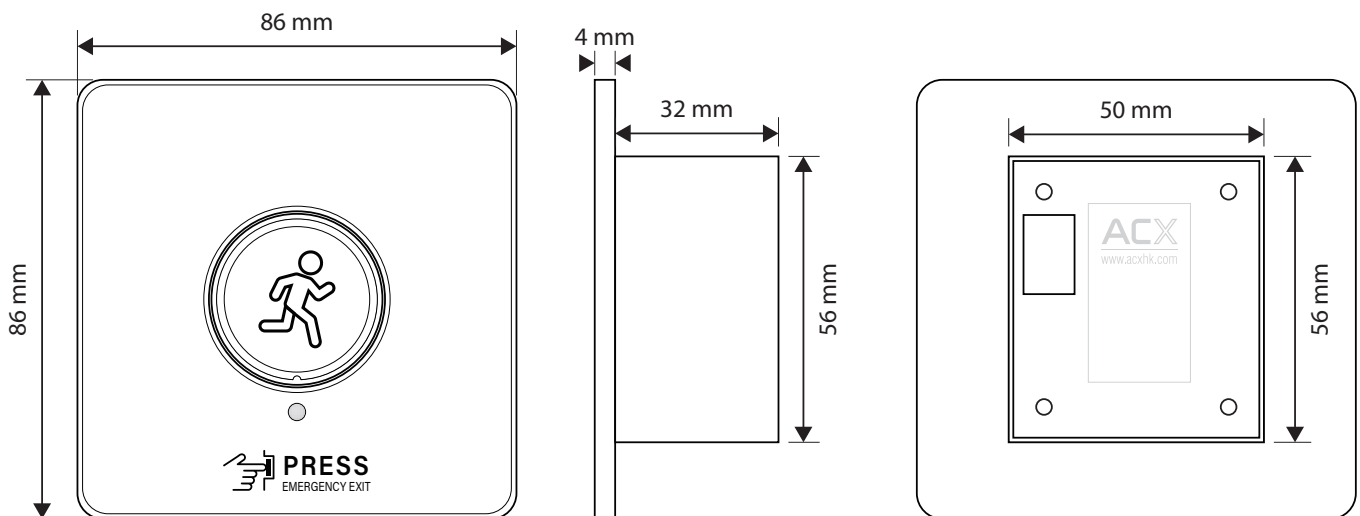

CABLE INSTALLATION GUIDELINE 接線安裝指南

RED	紅	2	Device Power IN 設備電源輸入
GREY	灰	4	RS232-RX
			N/A 不適用
YELLOW	黃	8	Alarm Output (COM) 報警輸出幹接點(共接點)
AMBER	橙	10	Alarm Output (NO) 報警輸出幹接點(常開)
BLUE	藍	12	Alarm Output (NC) 報警輸出幹接點(常閉)

BLACK	黑	1	Device Power Ground 設備電源接地
PURPLE	紫	3	RS232-TX
			N/A 不適用
			N/A 不適用
PINK	粉紅	9	E-Lock Power IN (NC) 電鎖電源輸入(常閉)
PINK	粉紅	11	E-Lock Power OUT (NC) 電鎖電源輸出(常閉)

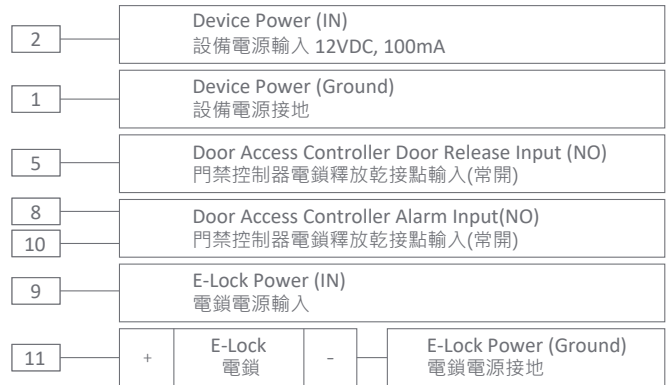
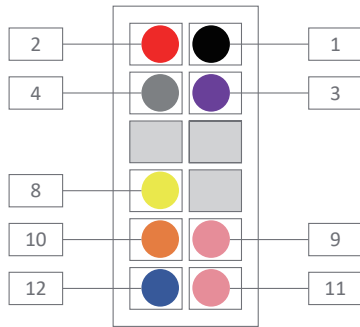

SCENARIOS

Press for emergency exit

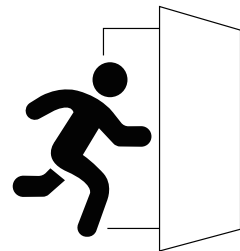
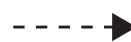
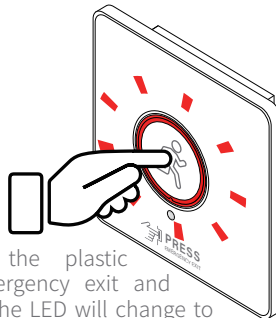
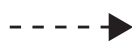

User presses the plastic button for emergency exit and alarm output. The LED will change to red. [The LED can be configured to flash mode and the buzzer can be configured to beep sound mode]

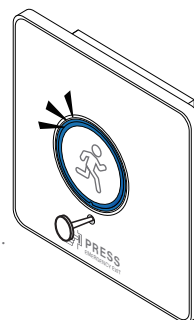

Use a stick to release the plastic button. The light will turn back to blue.